

Square door handle and key roses 50x50x7mm

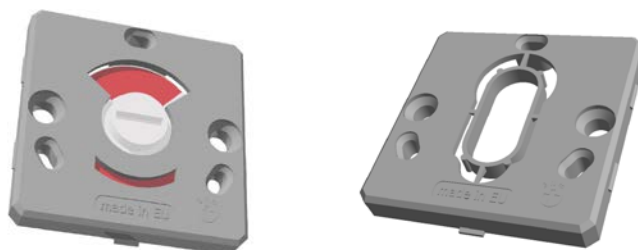

The key rosettes are obtainable in the following versions:

- ◆ with free-engaged indicator for WC;
- ◆ with oval (OB) + yale (PZ) hole;

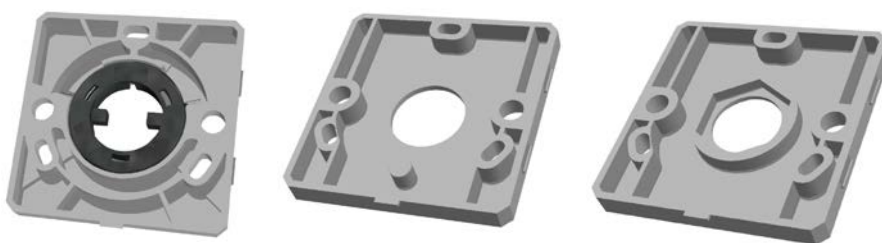

The door handle roses are available in the following versions:

- ◆ for torsion spring assembly;
- ◆ with integrated right-left spring;
 - with hole \varnothing 16 mm and square 7 or 8mm, with or without neck \varnothing 22mm;
 - with hole \varnothing 16 mm for milled handle, with or without neck \varnothing 22mm;
- ◆ with hexagon 17mm, hole \varnothing 14mm, neck \varnothing 22mm;

All these door handle and key roses are equipped with:

- ◆ 2 holes with or without nuts, with an interaxis of 38 mm for connecting screws;
- ◆ 3 oval holes for wood screws;



*They are combinable with the square screw cover rosettes 50x50x7mm
in stainless steel, brass or aluminium
with a yale (PZ), oval (OB), WC, or round hole.*